



Valve

- J4V
- J4V100
- J4V200
- J4V300
- J4V400

Manifold

- JSY
- 5JV
- MCS
- JVT307
- JEL

- MVSD
- VF

- BM
- NAMUR

- 551
- JEL10

- 3VJZF
- Diaphragm

- JELVD
- 3V1

- Coil
- 2P

- 2V
- 2W

- 2W(Big)
- 2L

- VX
- PU

- PU225
- 2Q

- JEL5404
- JEL6213

- BU
- Pulse

- JELJZF
- 4H

- TSV
- MPV

- 4HV
- HV, K

- 4R
- 4F210

- FV
- MSV

- JM
- ASC, RE

- QE, QEA
- ST

- HSV

Base Ordering Code

Specification	Series Code	Joint
Blank: 4V Series	100M: Sub-plate for 100 series valves	100M: 1~20F
3V: 3V Series	200M: Sub-plate for 200 series valves	200M: 1~20F
	300M: Sub-plate for 300 series valves	300M: 1~20F
	400M: Sub-plate for 400 series valves	400M: 1~20F

Accessory Ordering Code

Specification	Series Code	Joint
Blank: 4V Series	100M: Sub-plate for 100 series valves	B : Blanking plate
3V: 3V Series	200M: Sub-plate for 200 series valves	C: Sealing gasket
	300M: Sub-plate for 300 series valves	D: Screw
	400M: Sub-plate for 400 series valves	

Overall Dimension

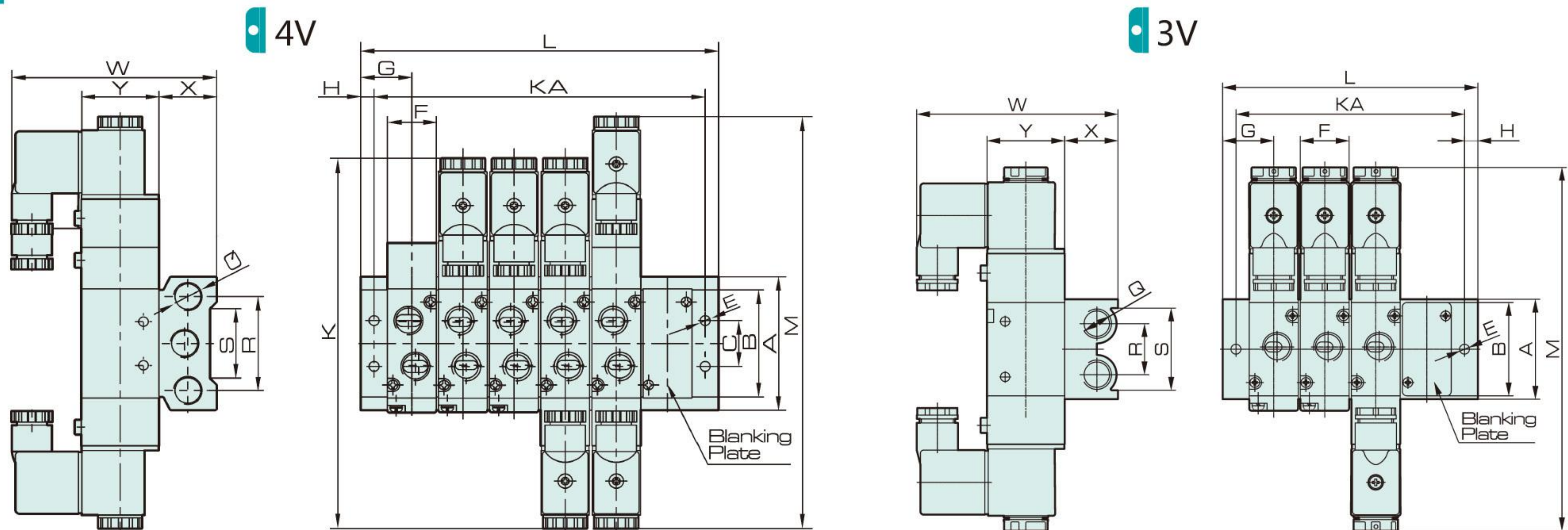

Specification

Inside Dia./ Symbol	A	B	C	E	F	G	K	KA	L	M	Q	R	S	W	X	Y
4V-100M-□F	58	43	20	4.2	18.3	19	140	(n-1)*19+28	(n-1)*19+38	155	G1/4	40	30	78.5	25	27
4V-200M-□F	59	50	21	4.3	22.2	23	170	(n-1)*23+34	(n-1)*23+46	189	G1/4	43	32	92.5	26	35
4V-300M-□F	75	64	26	4.5	27.3	27	189	(n-1)*28+42	(n-1)*28+54	208	G3/8	53	48	99	30	40
4V-400M-□F	98	94	32	5.5	34.3	31.5	222	(n-1)*35+49	(n-1)*35+63	243	G1/2	68	67	112	38	50

Inside Dia./ Symbol	A	B	E	F	G	H	KA	L	M	Q	R	S	W	X	Y
3V-100M-□F	31	30	4.5	18	18.5	4.5	(n-1)*19+28	(n-1)*19+37	130.8	G1/8	17.5	25	72.8	19	27
3V-200M-□F	45	43	4.5	22	23	6	(n-1)*23+34	(n-1)*23+46	163.4	G1/4	23	37	90.9	24	35
3V-300M-□F	50	47	4.5	27	27	6	(n-1)*28+42	(n-1)*28+54	190.5	G3/8	29	42	97.4	28	40
3V-400M-□F	62.5	62.5	5.5	34	31.5	7	(n-1)*35+49	(n-1)*35+63	191.9	G1/2	35.5	51.5	109.4	35	50