

# 2V Series

## 2/2 Way Solenoid Valve



2V010-M4-W

2V025-06T

2V025-08-J

2V130-15-J

### Ordering Code

2V	025	06	AC110V	V	J
Specification	Orifice Size	Port Size	Standard Voltage	Sealing	Wiring
2V: 2/2 way	010: 1.0 mm 025: 2.5 mm 130: 13 mm 250: 25 mm	M4: M4×0.7 06: 1/8" 08: 1/4" 10: 3/8" 15: 1/2" 20: 3/4" 25: 1"	DC12V DC24V AC24V 50Hz/60Hz AC110V 50Hz/60Hz AC220V 50Hz/60Hz AC380V 50Hz/60Hz	Blank: NBR V: Viton ( for high temperature gas)	J: Terminal W: Lead wire

### Symbol

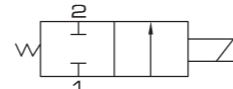

### Specification

Model	2V010-M4	2V025-06	2V025-08	2V130-10	2V130-15	2V250-20	2V250-25
Working Medium	Air, Water, Oil						
Operation	Direct			Internal piloted			
Type	Normal Close						
Orifice	1.0mm	2.5mm	13mm	13mm		25mm	
CV Value	0.04	0.23	6.2	6.2		23	
Port Size	M4×0.7	1/8"	1/4"	3/8"	1/2"	3/4"	1"
Operation Fluid Viscosity	Below 20 CST						
Working-pressure	0.05 ~ 0.7 MPa						
Max. Test Pressure	1.2MPa	1.6MPa	1.0MPa		1.0MPa		
Max. Ambient Temperature	-10 ~ 80°C						
Operating Voltage Tolerance	± 10%						
Protect Class	IP 65						
Power Consumption	AC: 6.5 VA DC: 6.5 W						
Insulation	F Class						
Material of Body	Aluminum or Brass (Nickel Plated)			Brass			
Material of Oil Seal	NBR Or VITON			NBR Or VITON			
Response Time	0.05 Sec.						

ISO9001:2015 CE

# 2V Series

## 2/2 Way Solenoid Valve

### Overall Dimension

#### 2V010-M4

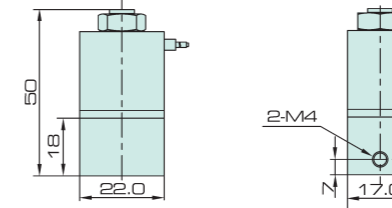

#### 2V025-06

#### 2V025-08

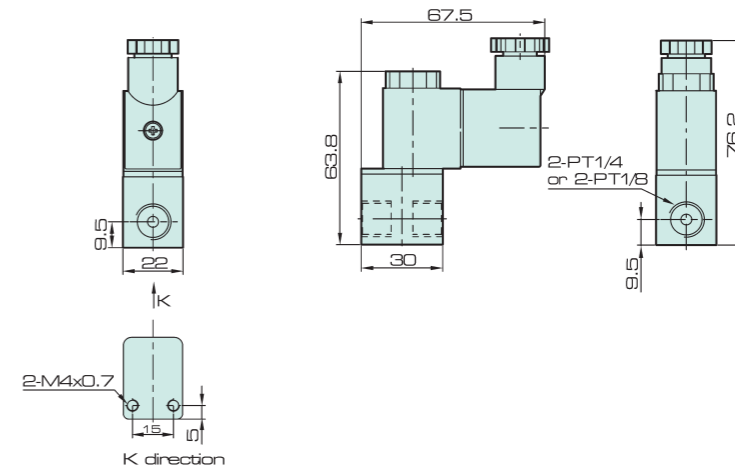

#### 2V130-10

#### 2V130-15

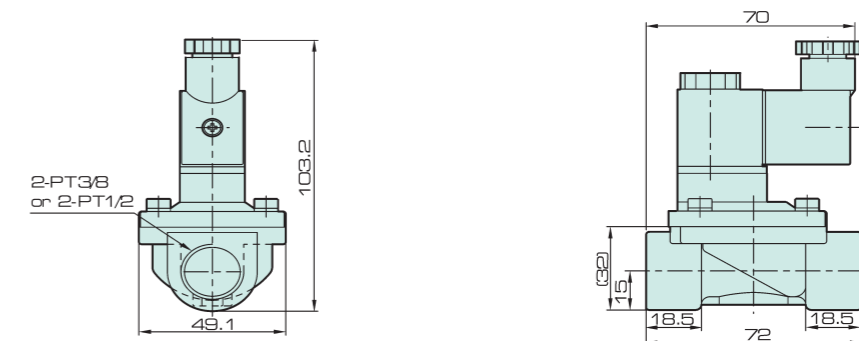

#### 2V250-20

#### 2V250-25

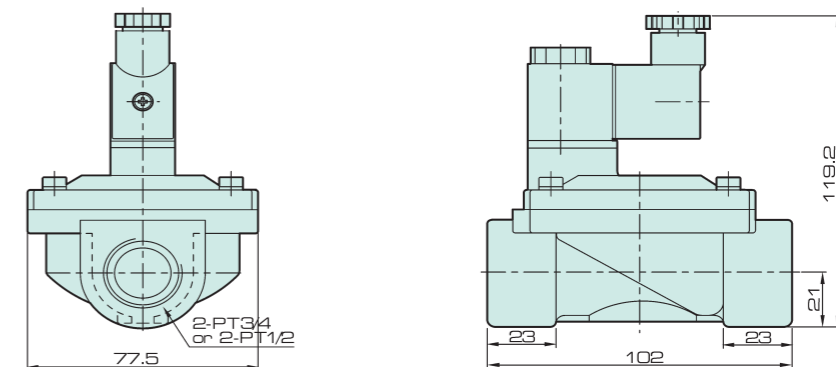

Valve  
J4V  
J4V100  
J4V200  
J4V300  
J4V400  
5V  
Manifold  
JSY  
5JV  
MCS  
JVT307  
JEL  
MVSD  
VF  
BM  
NAMUR  
551  
JEL10  
3VJZF  
Diaphragm  
JELVD  
3V1  
Coil  
2P  
2V  
2W  
2W(Big)  
2L  
VX  
PU  
PU225  
2Q  
JEL5404  
JEL6213  
BU  
Pulse  
JELJZF  
4H  
TSV  
MPV  
4HV  
HV, K  
4R  
4F210  
FV  
MSV  
JM  
ASC, RE  
QE, QEA  
ST  
HSV