



JEL5404-04-W



JEL5404-06-W



JEL5404-08-W



JEL5404-06-J

Ordering Code

JEL	5404	04	AC220V	J
JELPC	Model	Port Size	Standard Voltage	Wiring
		04: 1/2"	DC12V DC24V	J: Terminal
		06: 3/4"	AC24V 50/60Hz	W: Lead wire
		08: 1"	AC110V 50/60Hz	
			AC220V 50/60Hz	
			AC380V 50/60Hz	

Symbol

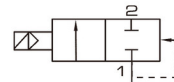

Specification

Model	JEL5404-04	JEL5404-06	JEL5404-08
Working Medium		Air, Water, Oil	
Operation		Internal Piloted	
Type		Normal Colse	
Orifice	12mm	20mm	25mm
KV Value	2.0	5.0	10.0
Port Size	1/2"	3/4"	1"
Applied pressure Range	Gas / Liquid: 0.1 ~ 5.0 MPa	Gas: 0.1 ~ 4.0 MPa Liquid: 0.1 ~ 2.5 MPa	Gas: 0.1 ~ 4.0MPa Liquid: 0.1 ~ 2.5MPa
Max. Test Pressure	7.5 MPa		6.0 MPa
Ambient Temperature Range		-10~150 °C	
Applied Voltage Range		± 10%	
Protection		IP 65	
Power Consumption		AC: 5.5VA DC: 9W	
Insulation		F Class	
Material of Body		Brass	
Material of Oil Seal		PTFE	

Overall Dimension

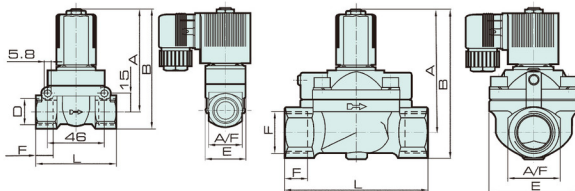

Dimension

Model	Orifice mm	Port Size	A	B	F	D	L	A/F
JEL5404-04	12.0	PT1/2"	83.0	95.5	14	32	65	27
JEL5404-06	20.0	PT3/4"	99.5	119	16	60	92	40
JEL5404-08	25.0	PT1"	99.5	119	16	60	92	40

Valve

- J4V
- J4V100
- J4V200
- J4V300
- J4V400
- 5V
- Manifold
- JSY
- 5JV
- MCS
- JVT307
- JEL
- MVSD
- VF
- BM
- NAMUR
- 551
- JEL10
- 3V1Z
- Diaphragm
- JELVD
- 3V1
- Coil
- 2P
- 2V
- 2W
- 2W(Big)
- 2L
- VX
- PU
- PU225
- 2Q
- JEL5404**
- JEL6213
- BU
- Pulse
- JELJZF
- 4H
- TSV
- MPV
- 4HV
- HV, K
- 4R
- 4F210
- FV
- MSV
- JM
- ASC, RE
- QE, QEA
- ST
- HSV