

JEL6213 Series Solenoid Valve



- Valve
- J4V
- J4V100
- J4V200
- J4V300
- J4V400
- 5V
- Manifold
- JSY
- 5JV
- MCS
- JVT307
- JEL
- MVSD
- VF
- BM
- NAMUR
- 551
- JEL10
- 3VJZF
- Diaphragm
- JELVD
- 3V1
- Coil
- 2P
- 2V
- 2W
- 2W(Big)
- 2L
- VX
- PU
- PU225
- 2Q
- JEL5404
- JEL6213
- BU
- Pulse
- JELJZF
- 4H
- TSV
- MPV
- 4HV
- HV, K
- 4R
- 4F210
- FV
- MSV
- JM
- ASC, RE
- QE, QEA
- ST
- HSV



JEL6213-04-J



JEL6213-06-J



JEL6213-08-J

Ordering Code

JEL	6213	04	AC220V	J
JELPC	Model	Port Size	Standard Voltage	Wiring
		02: 1/4"	DC12V DC24V	J: Terminal
		03: 3/8"	AC24V 50/60Hz	
		04: 1/2"	AC36V 50/60Hz	
		06: 3/4"	AC110V 50/60Hz	
		08: 1"	AC220V 50/60Hz	

Symbol

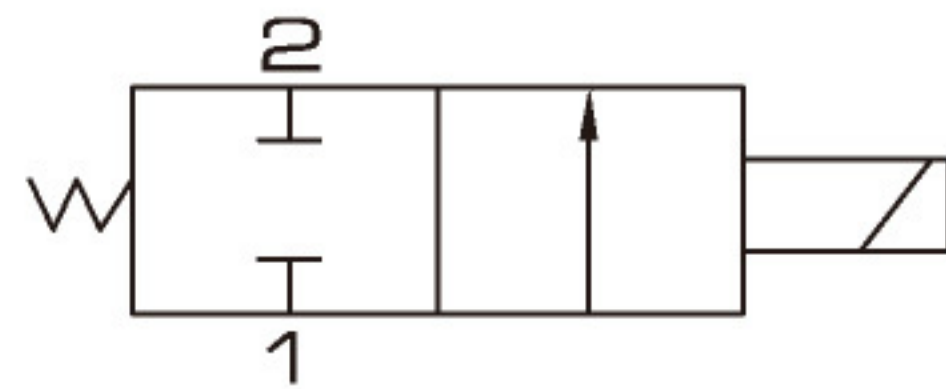

Specification

Model	JEL6213-02	JEL6213-03	JEL6213-04	JEL6213-04	JEL6213-06	JEL6213-06	JEL6213-08
Orifice	10mm			14mm		25mm	
Screw Port Size	PT1/4"	PT3/8"	PT1/2"	PT1/2"	PT3/4"	PT3/4"	PT1"
Working Pressure	0.03 ~ 1.0MPa						
Ambient Temperature	-10 ~ +55°C						
Medium Environment	-10 ~ +90°C						
KV Valve	2		3.6	8.3	8.3	11	11
Power	AC (VA)			14			
Consume	DC (W)			8			
Switching Frequency	≥1 Sec			≥0.5 Sec			

Overall Dimension

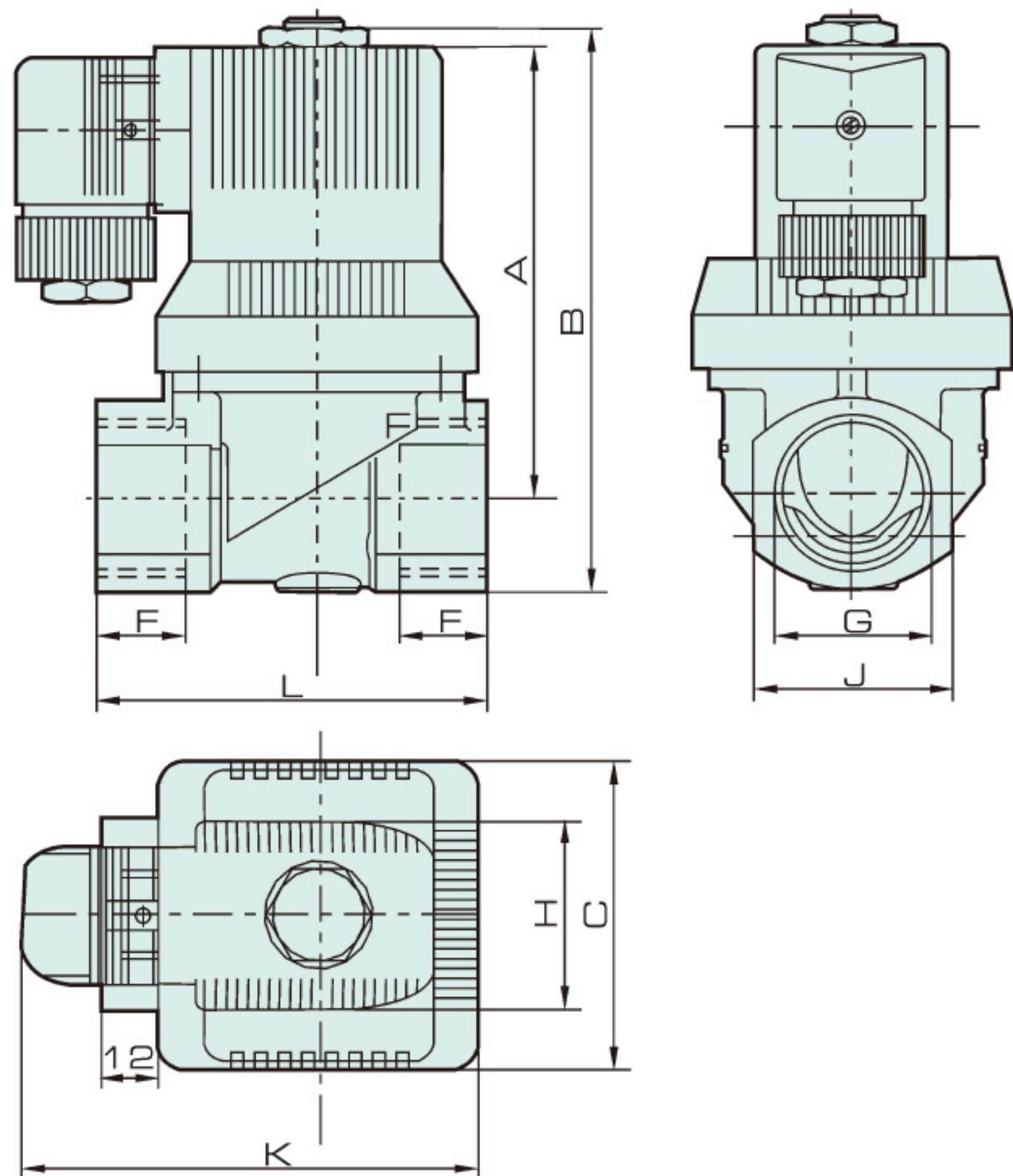

Dimension

Model	G	C	F	L	J	A	B	H	K
JEL6213-02	PT1/4"	38	14	50	26	71	85	35	71
JEL6213-03	PT3/8"	38	14	50	26	71	85	35	71
JEL6213-04	PT1/2"	38	14	50	26	71	85	35	71
JEL6213-04	PT1/2"	45	16	58	31	82	96	35	80
JEL6213-06	PT3/4"	45	16	58	31	82	96	35	80
JEL6213-06	PT3/4"	65	18	82	41	96	117	35	90
JEL6213-08	PT1"	65	18	82	41	96	117	35	90